

NEW CASTER ADJUSTMENT

PREVIOUS SYSTEM

Move back/forth



Fixed

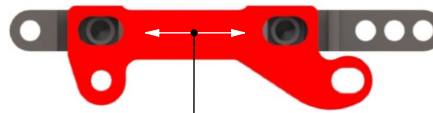

Adjustable

With a new caster adjustment system, the upper arm bracket can be moved back and forth, which is easier to adjust and prevents binding of the upper arm when making caster adjustments. Additionally, it gives a wider range of caster values.

Gauge

optional ①



① **B0557 is an optional tool recommended to use for bulkhead alignment, chassis tweak and caster value - all in one tool**

PREVIOUS SYSTEM

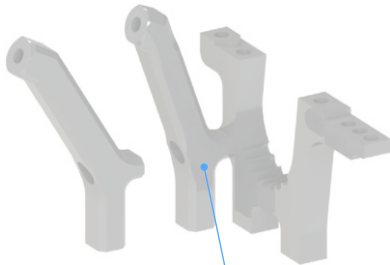

Fixed standard/
optional active
(A2542/A2543)

The new shock towers are lower, providing a flatter damper position. Active or fixed mounting can be chosen with the same parts, reducing the need for optional s.

SHOCK TOWERS included

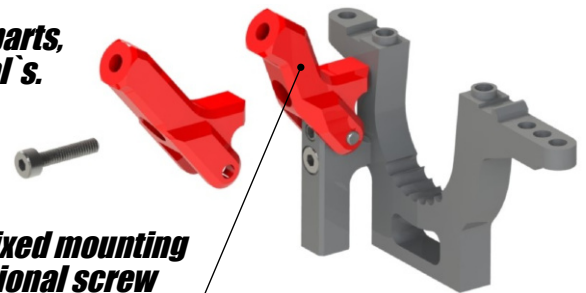

Active or fixed mounting
by additional screw
(front & rear)

PREVIOUS SYSTEM

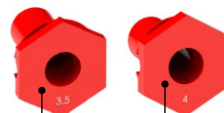

3.5mm HEX
optional (A2246-35)

4mm HEX
included

NEW DRIVE SHAFT'S included



New drive shafts with ball bearings for reduced friction, reduced vibration and maximum reliability. New black wheel hexes provide a 100% straight mounting area.

included



optional (A2248D)

MOTOR MOUNT

PREVIOUS SYSTEM

Bigger dimensions

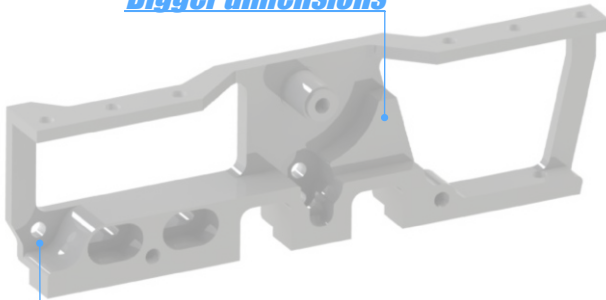

Only one fixed bearing position

Compact design



Adjustable belt tensioner

The motor mount is more compact and has two positions to mount an additional belt tensioner bearing, to allow fine tuning of belt tension.

STEERING SYSTEM

PREVIOUS SYSTEM

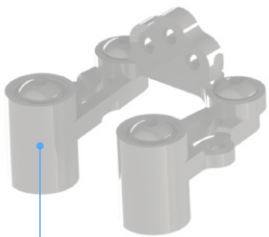

Double bellcrank steering

New steering plate

A new single bellcrank steering is fitted directly to the low profile servo mount, reducing play to a minimum and providing maximum precision when driving the car. It has two steering rod positions (short/long).



PREVIOUS SYSTEM

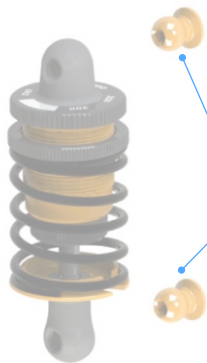

5mm ball with 2mm HEX.

6mm diameter balls with 2.5mm hex, improving reliability. A new silicone X-ring reduces friction of the shock absorber shaft.

SHOCK ABSORBER PARTS

New X-ring included



6mm ball with 2.5mm hex.

Hard upper arm optional (A2148-H)



Turnbuckle/camber wrench optional (B0557)



OTHER NEW PARTS



New composite parts made from extremely hard material:
-Front bumper plate
-Body height adjuster
-Body stopper
-Lower arm damper mount

